

GENERAL FEATURES

- **GEL Technology** - The success of DG batteries comes from the internationally superior Gel technology. It is ideal for standby or frequent cyclic discharge applications under extreme environments
- **Front Access Connection** - Front access connection for fast, easy installation and maintenance with standard width for 19' and 23' ETSI racks.
- **Long Service Life** - Especially designed for telecommunication use with 10+ years design life in float service. By combining the newly developed paste formula with up-to-date GEL structures, this range features 12 years design life.
- **Maintenance-Free, Non-Spillable** - Proven VRLA technology guarantees safe operation without maintenance and 'non-restricted article' status for transportation.
- **Designed-In Reliability** - Cutting-edge manufacturing and process control combined with meticulous quality assurance procedures guarantee consistent and dependable performance

PERFORMANCE SPECIFICATIONS

Nominal Voltage	12V(6 cells)	
Design Floating Life @25°C	12 Years	
Nominal Capacity @25°C	20 hour rate	105.0Ah
	5.25A to 10.50V	
	10 hour rate	91.2Ah
	9.12A to 10.50V	
	5 hour rate	79.5Ah
	15.9A to 10.50V	
	3 hour rate	71.7Ah
	23.9A to 9.60V	
	1 hour rate	58.7Ah
	58.7A to 9.60V	
	Full Charged Battery@25°C	<7.5mΩ
Internal Resistance		
Energy Density (20-hr. rate)	95.54W-h/l	
Specific Energy (20-hr. rate)	38.77W-h/kg	
Shelf Life (nominal capacity at 20°C)	1 Month	97%
	3 Months	91%
	6 Months	83%
Max Short-Duration Discharge Current	5 Sec	1050A
Standby Use Charge (Constant Voltage) @25°C	Initial Charging	
	Current Less than 21A Voltage 13.6 - 13.8V	
Cycle Use Charge (Constant Voltage) @25°C	Initial Charging	
	Current Less than 21A Voltage 14.4 - 14.9V	
Operating Temperature Range	Charge	-20°C to 50°C
	Discharge	-40°C to 60°C

GENERAL FEATURES mm

Unit: mm

Length	410±1	Total Height	286±1
Width	110±1	Weight(kg)	33.0±1
Height	286±1		

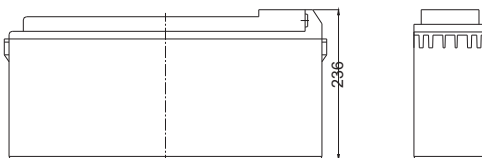

TERMINALS mm

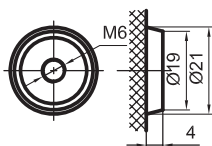

F8 Terminal

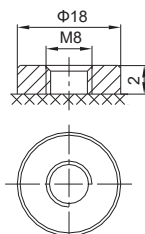

F14 Terminal

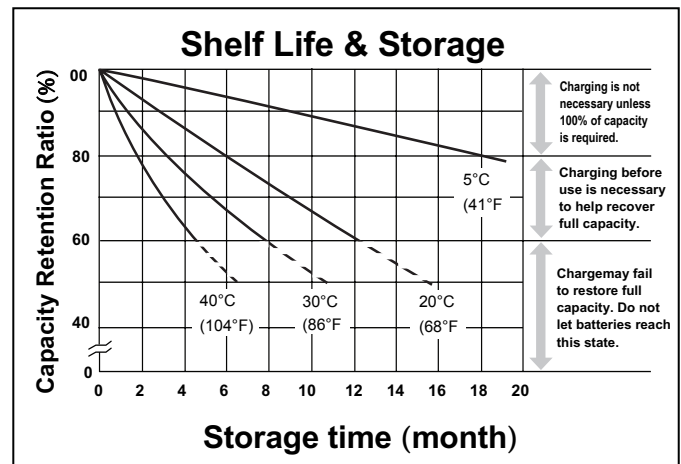
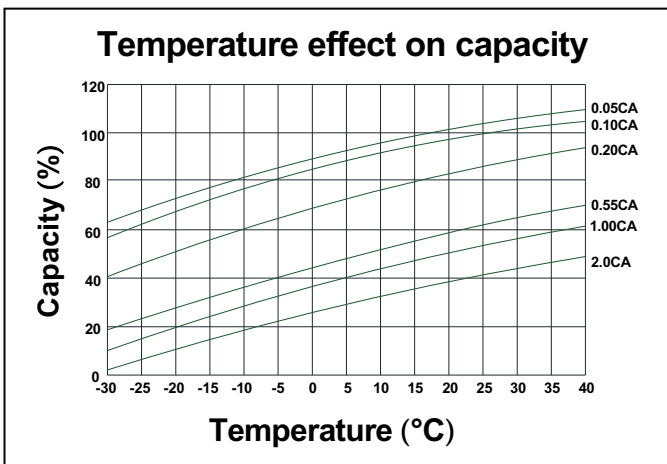
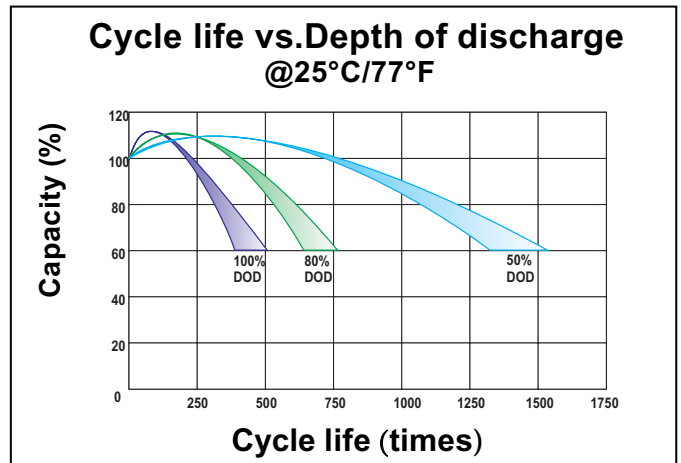
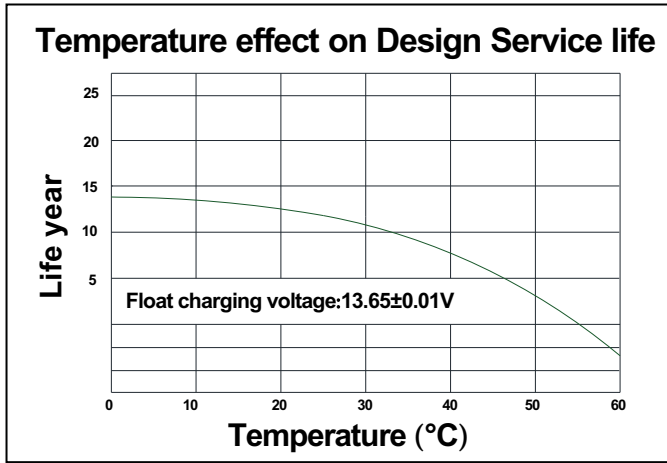
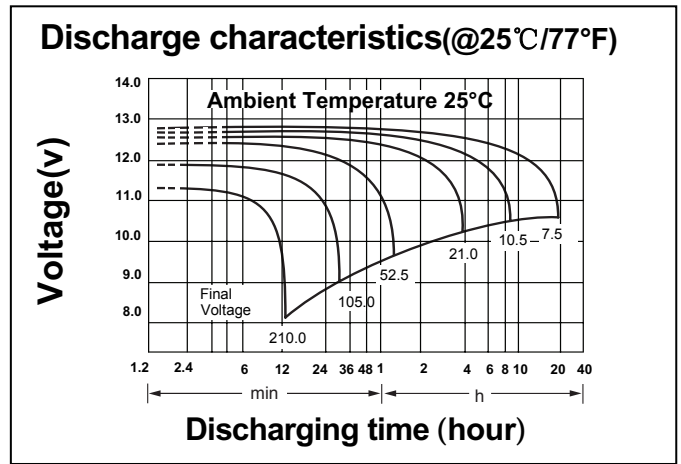
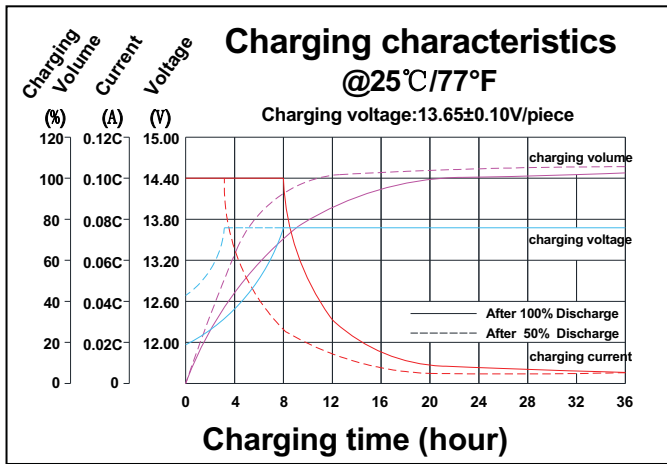

CONSTANT CURRENT DISCHARGE RATINGS (Amperes at 25°C)

F.V./Time	15MIN	30MIN	1HR	2HR	3HR	4HR	5HR	8HR	10HR	20HR
1.60V	143.7	96.3	58.7	35.1	24.3	19.9	16.3	11.2	9.48	5.78
1.65V	140.7	95.4	58.4	34.9	24.2	19.8	16.2	11.1	9.39	5.57
1.70V	138.5	94.8	57.9	34.6	24.0	19.7	16.1	11.0	9.30	5.41
1.75V	133.4	93.4	57.3	34.3	23.9	19.5	15.9	10.9	9.21	5.25
1.80V	124.4	90.1	56.0	33.7	23.3	19.1	15.6	10.8	9.12	4.94
1.85V	112.9	85.3	53.2	32.2	22.2	18.1	14.9	10.3	8.85	4.73